

VARUN E-BIKE

USER

MANUAL

Note: Please read through the user manual before using the bicycle for the first time.

| HOW TO GET WARRANTY



Register your branded product warranty through the methods below with your [order number](#) to ensure uninterrupted coverage. Once registered, support will be accessible not only through Amazon but also via [multiple dedicated channels](#), ensuring [faster](#) assistance.



During the warranty period, you will enjoy [priority service](#).



SMS Numbers: + 44 7749 895645



WhatsApp Numbers: + 44 7749 895645

WhatsApp Link: <https://wa.me/447749895645>



Email Service: support@varunebike.com

| HOW TO INSTALL AN E-BIKE



Please access the installation video via the following methods:

Option 1: Scan the QR code below with your camera.



Scan me

Option 2: Enter the link below to get the video.



Installation video link: <https://bit.ly/4gAr7O3>

Here you can find installation  for each model

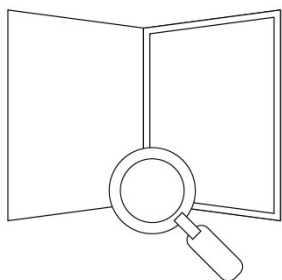

OPERATOR'S MANUAL

TABLE OF CONTENTS

RETURN POLICY	01
VARUN MESSAGE	02
01. WARM TIPS	03
02. ALL MODELS OF VARUN CITY E-BIKES	04
03. PACKING LIST	06
04. SCHEMATIC STRUCTURE AND PARAMETERS OF E-BIKE	07
05. PARAMETERS	08
06. CHARACTERISTICS	12
07. INSTALLATION	12
08. INSTRUCTIONS FOR USE	17
09. ADJUSTMENT AND USE OF BRAKE	19
10. CHARGING: GUIDELINES FOR SAFE HANDLING	19
11. ERROR CODES	20
12. PRODUCT TROUBLESHOOTING AND METHODS	20
13. PRODUCT PRECAUTIONS	21
14. PRODUCT MAINTENANCE INSTRUCTIONS	22
15. WARRANTY STATEMENT	26
16. FAQ	26
17. AFTER-SALES SERVICES	27

RETURN POLICY

General Guidelines

1.IMPORTANT: Please contact VARUN customer service before returning your e-bike, do not return your e-bike without prior consultation. Otherwise the parcel will be refused and any costs incurred will be borne by the buyer.

– Quality-related returns (damage/wrong items): If the return is due to quality, damage and wrong items (corresponding pictures or videos must be provided), VARUN will cover the return shipping cost and provide a prepaid return label.

– Non-quality returns (buyer's discretion): If the return is not related to quality, damage or incorrect items but only due to the buyer's personal and last-minute discretion, the buyer will be responsible for the return shipping costs.

2.Condition Requirements:

– Returned equipment must be in like-new condition, including all original packaging, accessories and documentation. Any missing components may be deducted from the refund. Any shipping damage during the return process may be deducted from the refund.

3.Refund Process:

– Refunds will be issued within an average of 1 week after we have received, inspected and processed the returned item. Your refund will be returned to your original method of payment.

PLEASE NOTE

– If there is a quality issue, buyer must provide product pictures or videos to VARUN in advance. If no picture or video is sent to VARUN in advance, VARUN will partially deduct the payment according to the damage degree of the returned product received;

– Warranty can only be claimed at your dealer or VARUN customer service.

VARUN MESSAGE

Dear friends, thank you for choosing VARUN among many e-bike brands:

VARUN Electric Bike is committed to providing people with a safer, more comfortable and environmentally friendly way of traveling, paying great attention to functionality, design, quality and customer experience. We strive to sell our best quality products at the most competitive prices while providing you with the best service. You will not be disappointed when you choose VARUN.

When you receive your VARUN e-bike, you are welcome to send your order number + bike serial number (frame head tube location) to our support center at ***support@varunebike.com*** and we will activate the one year warranty for you.

We also expect you to tell us your experience and suggestions after riding without reservation, we will continue to improve our e-bikes to bring more customers a pleasant riding experience.

| 01. WARM TIPS

This manual contains important information about safety performance and service. Before using the product, please read the following warnings.

1.1 For riding safety, please carefully read the Product Manual before riding and check whether the parts are intact. For any problems, please contact us timely: **support@varunebike.com** Always wear a helmet.

1.2 Wear the helmet when riding the electric bike.

1.3 Please keep both keys properly.

1.4 Make sure your e-bike has a full battery before you ride it.

1.5 Always respect pedestrians.

1.6 Do not ride in humid condition. Electric bike may slip off your feet and cause injury. Humid environment may cause electronic device damage and warranty failure.

1.7 Please always observe the local laws and regulations on electric bicycles.

1.8 Do not disassemble the parts; if necessary, please contact us for purchasing standard parts.

1.9 Avoid exposure to sunlight or rain for a long period, and avoid storing our electric bicycle at a hot place or a place with corrosive gas to prevent damage to electroplated parts and painted surfaces.

1.10 To obtain the best endurance mileage, follow the following instructions:

Please use the pedal assist mode.

- Do not brake frequently under the premise of ensuring safety.

- Do not brake frequently under the premise of ensuring safety.
- Do not overload.
- Before riding, please check the tire pressure; the tires shall have enough pressure, generally 20PSI (140Kpa 1.4BAR)

1.11 E-bikes are a risky mode of transportation, so be sure to follow the rules of the road. In the event of an emergency such as riding too fast, brake the rear wheel first and then the front wheel. If you brake the front wheel suddenly, there is a danger of falling over, so please ride carefully.

1.12 Before riding this electric bike, please carefully check the state of the body. You shall be responsible for any consequences caused by your improper operation or use.

1.13 Each bike has its own frame number, located in the head tube position of the frame. When you receive this e-bike, please record and save the frame number, frame number. We have no record.

1.14 Please comply with local laws and regulations. If the use of the speed regulating handle (or called rotary handle and accelerator) is not allowed according to local laws, do not install and use the speed regulating handle on VARUN products; otherwise, you shall bear all the consequences, and VARUN shall not assume any responsibility.

1.15 Before your first ride, check that all parts/screws of your e-bike are tightened or locked (wheel clamps, saddle clamps, etc.).



02. ALL MODELS OF VARUN FATTENING E-BIKES

Plorer Silvery



Plorer Black



X-Plorer Silvery



X-Plorer Black



X-Plorer Raptor White



X-Plorer Raptor Yellow



X-Plorer Beast White



X-Plorer Beast Yellow



X-Plorer Monster White



X-Plorer Monster Yellow



M26-2 PRO White



M26-2 PRO Black



M26-2 PLUS White



M26-2 PLUS Black



S26-1 White



S26-1 Black



| 02. ALL MODELS OF VARUN FATTENING E-BIKES

S20-1 Black



S20-1 Grey



S20-1 Plus Black



S20-1 Plus Orange



03. PACKING LIST

Please carefully inspect the contents of the package and contact VARUN customer service support if anything is missing or damaged.

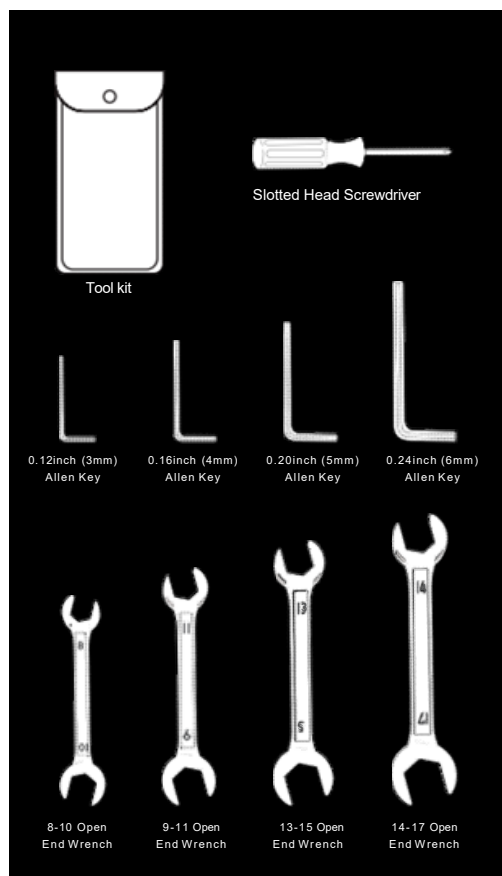

1x Electric Bicycle (80% assembled)	1x Front Wheel	1x Charger
1x Saddle	1x Toolkit	2x Pedals
2x Keys	1x Reflector/Tail Light	1x Instruction Manual

| 04. SCHEMATIC STRUCTURE AND PARAMETERS OF E-BIKE

4.1 Urban E-Bike Series (M26-2 PRO as an example)

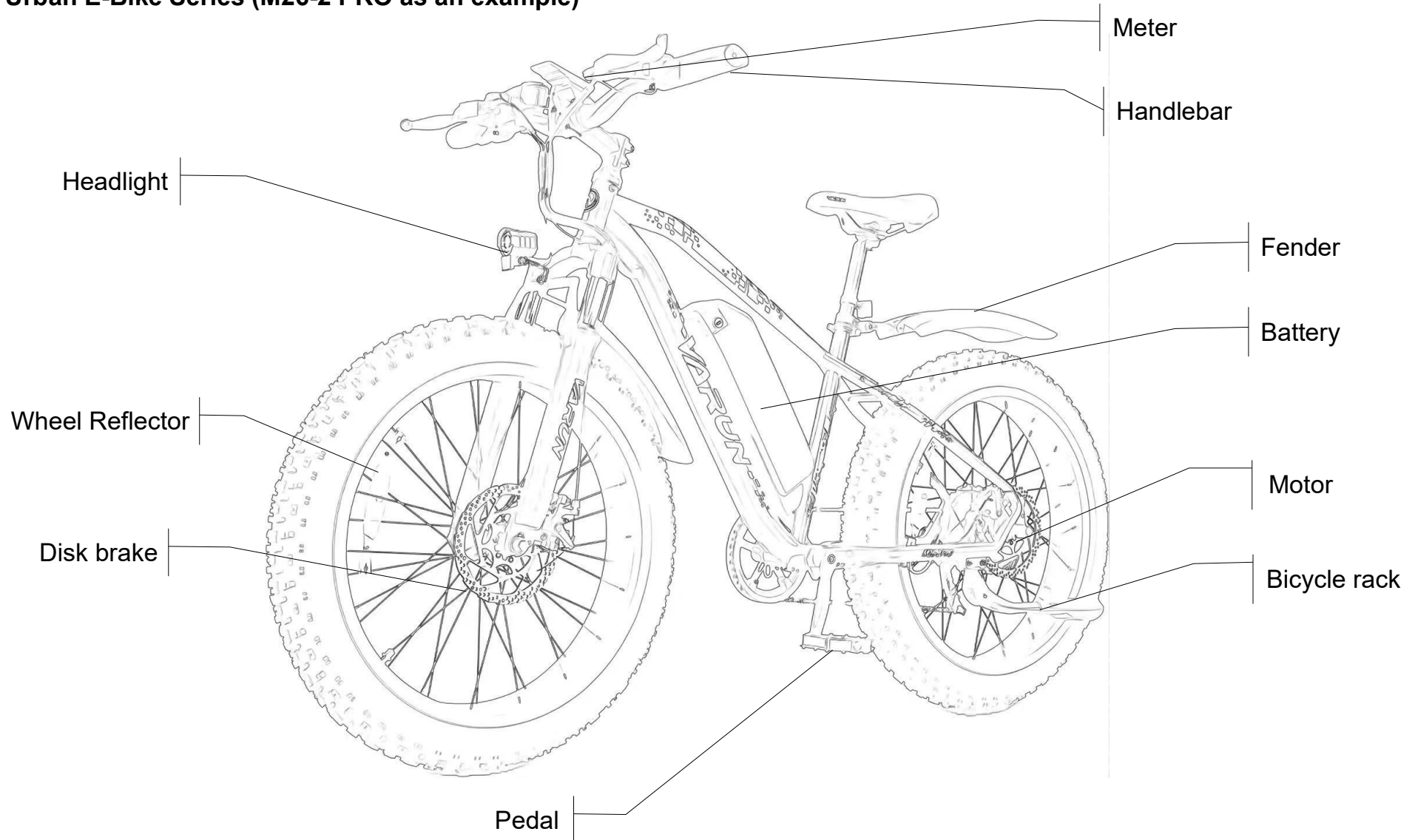

05. PARAMETERS

Please confirm the product model and find corresponding parameters.

Performance Indicators	Items	Plorer	X-Plorer	X-Plorer Raptor	X-Plorer Beast	X-Plorer Monster	M26-2 PRO	M26-2 PLUS
Basic parameters	Dimensions	138*54*118CM	164*61*114CM	179*63*104CM	179*63*104CM	179*63*104CM	191*69*105CM	191*69*105CM
	Wheel dimension	16"	20"	20"	20"	20"	26"	26"
	Frame material	Iron	Iron	Iron	Iron	Iron	Iron	Iron
	Load capacity	150KG	150KG	150KG	150KG	150KG	150KG	150KG9
	E-bike weight	30.5KG	36.5KG	50.4KG	52.7KG	53.2KG	29.2KG	31.5KG
Performance Parameters	Max. speed	25km/h	25km/h	25km/h	25km/h	25km/h	25km/h	25km/h
	Max. gradient	9-10°	9-10°	9-10°	9-10°	9-10°	9-10°	9-10°
	Front derailleur	Single speed	Single speed	Single speed	Single speed	Single speed	Single speed	Single speed
	Rear derailleur	7-Speed	7-Speed	7-Speed	7-Speed	7-Speed	7-Speed	7-Speed
	Working temperature	-20°C ~45°C	-20°C ~45°C	-20°C ~45°C	-20°C ~45°C	-20°C ~45°C	-20°C ~45°C	-20°C ~45°C
Battery parameters	Rated voltage	48V	48V	48V	48V	48V	48V	48V
	Battery capacity	13AH	13AH	20.8AH	31.5AH	31.5AH	13AH	15AH

Performance Indicators	Items	Plorer	X-Plorer	X-Plorer Raptor	X-Plorer Beast	X-Plorer Monster	M26-2 PRO	M26-2 PLUS
Motor parameters	Rated power of motor	250W	250W	250W	250W	250W	250W	250W
	Motor type	Brushless hub motor	Brushless hub motor	Brushless hub motor	Brushless hub motor	Brushless hub motor	Brushless hub motor	Brushless hub motor
Charger parameters	Input voltage	100-240V	100-240V	100-240V	100-240V	100-240V	100-240V	100-240V
	Input current	≤2.8A	≤2.8A	≤2.8A	≤3A	≤3A	≤2.8A	≤2.8A
	Output voltage	54.6V	54.6V	54.6V	54.6V	54.6V	54.6V	54.6V
	Output current	2A	2A	2A	3A	3A	2A	2A
Other parameters	Charging time	4-6H	4-6H	6-8H	6-8H	6-8H	4-6H	4-6H
	Instrument	LCD instrument	LCD instrument	LCD instrument	LCD instrument	LCD instrument	LCD instrument	LCD instrument
	Brake	Disc brake	Disc brake	Disc brake	Disc brake	Disc brake	Disc brake	Disc brake
	Anti-vibration mounting	Spring shock absorber	Spring shock absorber	Spring shock absorber	Spring shock absorber	Spring shock absorber	Spring shock absorber	Spring shock absorber
	Car light	Front and rear lamps	Front and rear lamps	Front and rear lamps	Front and rear lamps	Front and rear lamps	Front and rear lamps	Front and rear lamps
	Package weight	35.5KG	43.5KG	54.4KG	57.7KG	58.5KG	35.5KG	36.5KG
	Battery lock	Yes (2 keys)	Yes (2 keys)	Yes (2 keys)	Yes (2 keys)	Yes (2 keys)	Yes (2 keys)	Yes (2 keys)

Performance Indicators	Items	S20-1	S20-1 PLUS	S26-1
Basic parameters	Dimensions	173*61*126CM	173*61*126CM	196*66*113CM
	Wheel dimension	20"	20"	26"
	Frame material	Aluminum	Aluminum	Aluminum
	Load capacity	150KG	150KG	150KG
	E-bike weight	29KG	30KG	35KG
Performance Parameters	Max. speed	25km/h	25km/h	25km/h
	Max. gradient	9-10°	9-10°	9-10°
	Front derailleur	Single speed	Single speed	Single speed
	Rear derailleur	7-Speed	7-Speed	7-Speed
	Working temperature	-20°C ~45°C	-20°C ~45°C	-20°C ~45°C
Battery parameters	Rated voltage	48V	48V	36V
	Battery capacity	13AH	13AH	18AH

Performance Indicators	Items	S20-1	S20-1 PLUS	S26-1
Motor parameters	Rated power of motor	250W	250W	250W
	Motor type	Brushless hub motor	Brushless hub motor	Brushless hub motor
Charger parameters	Input voltage	100-240V	100-240V	100-240V
	Input current	≤2.8A	≤2.8A	≤2.8A
	Output voltage	54.6V	54.6V	54.6V
	Output current	2A	2A	2A
Other parameters	Charging time	4-6H	4-6H	4-6H
	Instrument	LCD instrument	LCD instrument	LED instrument
	Brake	Disc brake	Disc brake	Disc brake
	Anti-vibration mounting	Spring shock absorber	Spring shock absorber	Spring shock absorber
	Car light	Front and rear lamps	Front and rear lamps	Front and rear lamps
	Package weight	36.5KG	36.7KG	41.1KG
	Battery lock	Yes (2 keys)	Yes (2 keys)	Yes (2 keys)

4.1 Warm Tip

- Weight less than 120kg comprehensive riding experience feel better.
- Speed and range vary depending on road conditions, weather, rider weight etc.

| 06. CHARACTERISTICS

- 6.1 Three-dimensional body structure is designed according to ergonomics, mechanics of materials and aesthetics, contributing to the best riding effect.
- 6.2 Light and stylish appearance and excellent part material safeguard riding and facilitate riding operation.
- 6.3 For riding safety, the electric safety system will cut off power automatically when braking.
- 6.4 The bicycle is designed according to EU laws (rated speed: 25KM/H), safeguarding riding.
- 6.5 The bicycle complies with the local laws and regulations and can be thus used safely.
- 6.6 The bicycle is equipped with a mechanical bell. While riding the bicycle, the sound of bell and motor does not exceed the A-weighted emission sound pressure level requirement of 70dB(A) at workplace.

| 07. INSTALLATION

When you receive the product, please check the list of accessories carefully, please pay attention to safety when installing, and follow the following steps to assemble the vehicle. For your safety, please wear protective gloves before installation.

Note: The installation steps will be slightly different depending on the product model, the specific in kind shall prevail, please find the corresponding installation steps according to the product model you purchased.

For your safety, please wear protective gloves before installation.

Improper assembly may cause risks of loss of control, bumping or falling. Please apply proper force when assembling the bicycle. Too tight or too loose tightening may cause damage or failure of the electric bicycle. Special Note: Do not assemble or repair the bicycle without powering it off.

Any use of unauthorized parts, wrong installation may result in damage to electric bicycle or even personal injury. Do not attempt to ride an electric bicycle that is not properly installed.

Do not disassemble or modify the bicycle at will. Otherwise, it may cause permanent damage to the bicycle and personal injury.

7.1 Installation Of Handlebars

7.1.1 Suitable For M26-2 PRO/M26-2 PLUS/S26-1 Model.

- Turn the handlebar cross tube 180 degrees so it faces forward and tighten the 2 bolts with a No.2 (M4 wrench) tool to secure the handlebar in place.



7.1.2 Suitable For Plorer/X-Plorer/X-Plorer Raptor/X-Plorer Beast/X-Plorer Monster Model.

- Loosen the two screws in the picture first then turn the handlebar cross tube 180° so that it is facing forward. After that, retighten the two screws and finally secure the screws at the top of the cross tube as well.

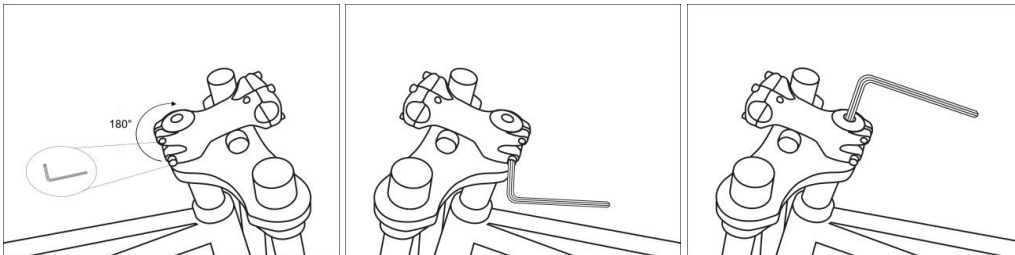

7.1.3 Suitable For S20-1/S20-1 PLUS Model.

- Insert the upper part of the handle riser into the lower part, locking the retaining structure in the middle of the handle riser.
- Stand the riser vertically and lock the folders at the bottom of the riser.
- Make sure the handlebar structure is secured and the handlebars are not wobbly.

Note: When adjusting the height of the handle riser, do not exceed the limit line!

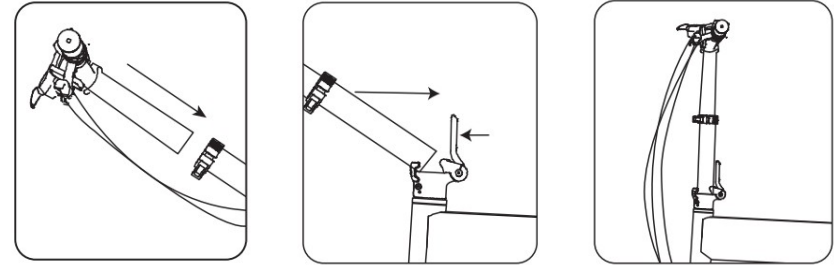

7.2 Adjust The Handlebar Angle

7.2.1 Suitable For M26-2 PRO/M26-2 PLUS/S26-1 Model.

- Use a No.2 (M4 wrench) tool to unscrew the 4 bolts from the stem cover and rotate the handlebars so they are perpendicular to the bike frame; tighten the stem cover against the handlebars and install the 4 bolts back into the stem; tighten the screws again using a No.2 (M4 wrench) tool.

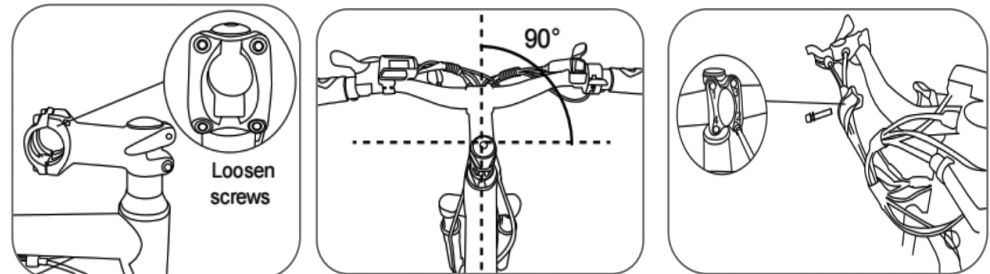

7.2.2 Suitable For Plorer/X-Plorer Model.

- Use a 6-angle wrench to unscrew the 4 bolts on the stem cover, then rotate the handlebars so they are perpendicular to the bike frame; tighten the stem cover on the handlebars, then put the 4 bolts back into the stem; use a 6-angle wrench to tighten the screws again.

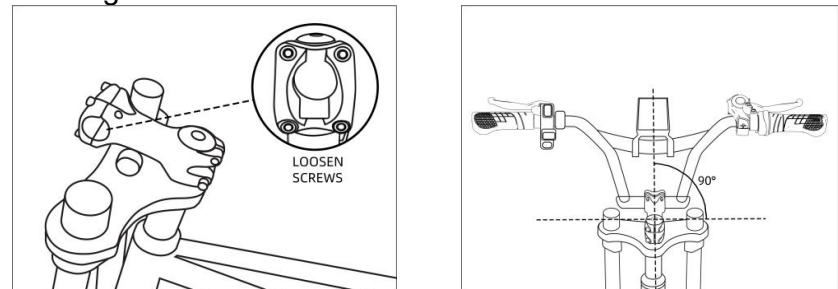

7.3 Installation Of Front Wheel

7.3.1 If the front wheel axle of your Ebike is hollow, please install the front wheel according to the following instructions.

- Use a No.8 (M17 wrench) tool to loosen the fork retaining bar and remove it (this accessory is to prevent the fork from deforming during delivery).

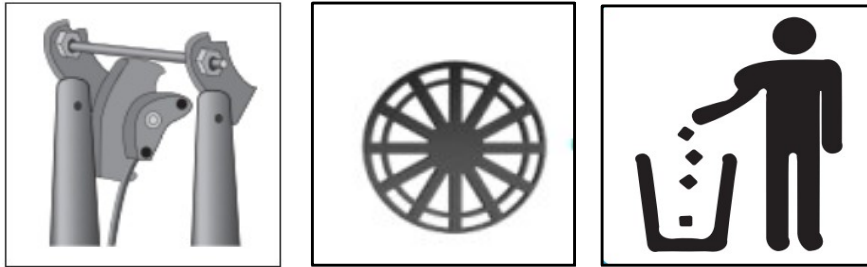

- Insert the front wheel in between the front fork on the bike. Be sure the fork is resting on the outside of the axle.
- Align the disk between the brake caliper as shown in Figure.
- Insert the skewer into the wheel axle as seen shown. Keep the spring, cam follower, and lever on the LEFT side, nearest the disk brake. Keep the adjustment nut and spring on the RIGHT side.
- Screw the skewer into the end nut until almost tight. Lift the lever up until parallel with the front fork. You should feel the axle tighten into the front forks. Your front wheel is now installed.

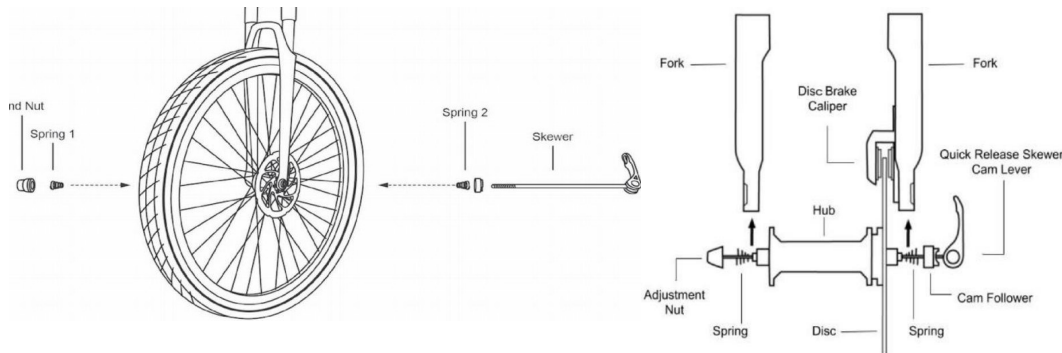

7.3.2 If your Ebike front wheel axle is solid, please follow the steps below to install the front wheel.

- Use a No.8 (M17 wrench) tool to loosen the fork retaining bar and remove it (this accessory is to prevent the fork from deforming during delivery).

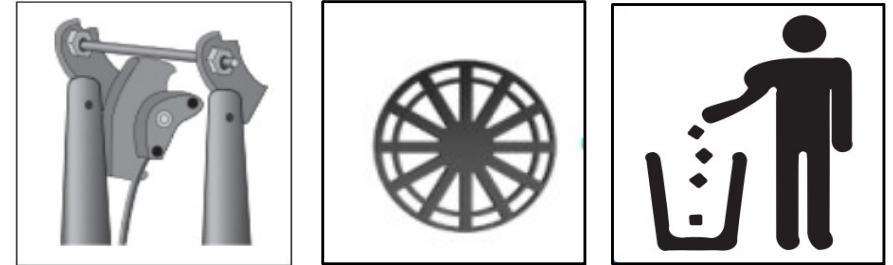

- Place the front wheel into the forks, make sure the fork hangers are secured to the axle and make sure the disc is placed in the middle of the brake, tighten the flange nuts on both sides using a No.7 (M15 wrench) tool.

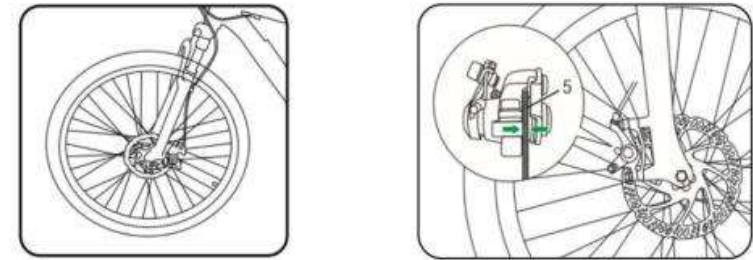

7.4 Installation Of Fenders

7.4.1 Suitable For M26-2 PRO/M26-2 PLUS/S26-1 Model.

- Front fender + Headlight: Loosen the screws in the corresponding positions on the front wheels, place the fenders and headlights in that position as shown below, adjust the angle of the headlights, and retighten the screws.

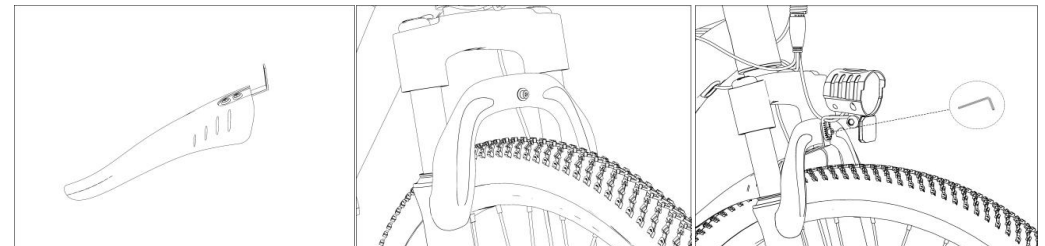

- Rear mudguard: Locate the rear fender from the box, place the seat tube in the proper position, adjust the angle and use a screwdriver to tighten the screws.

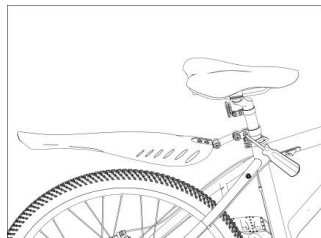
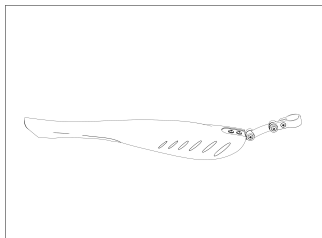

7.4.2 Suitable For Plorer/X-Plorer Raptor /X-Plorer Beast/X-Plorer Monster/S20-1/S20-1 PLUS Model

- Loosen the screws at the corresponding locations on the front wheels as shown below. Place the fender in that position and retighten the screws by aligning the holes.

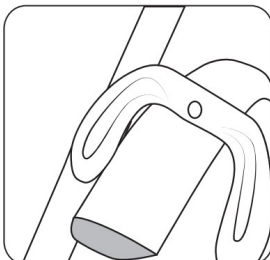
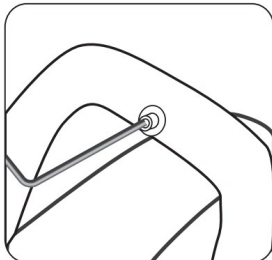
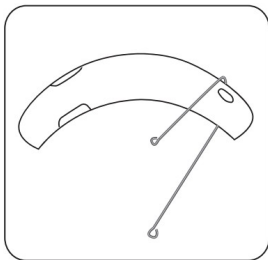

- Remove the headlights and place them in the appropriate position as shown below. After adjusting the angle of the headlights, tighten the screws on both ends with a wrench. (Suitable For Plorer/X-Plorer Raptor /X-Plorer Beast/X-Plorer Monster Model)

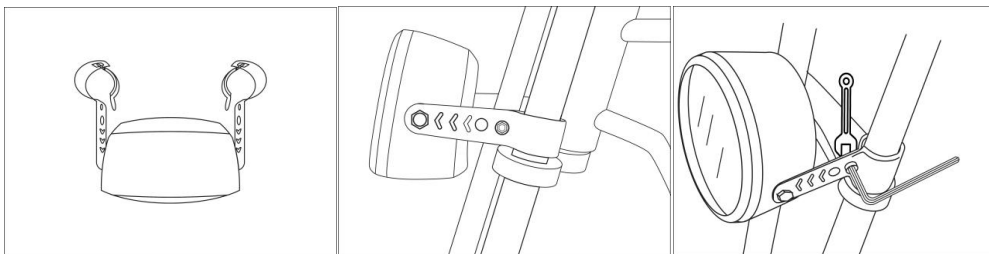

- Attach the headlights and refasten the loose screws. Adjust the position of the lights and tighten the screws. (Suitable For S20-1/S20-1 PLUS)

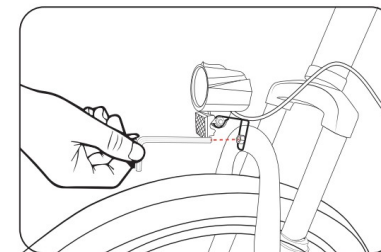
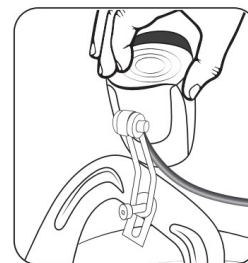

- Loosen the screws that hold the baffle in place, secure the baffle, and then tighten them again.

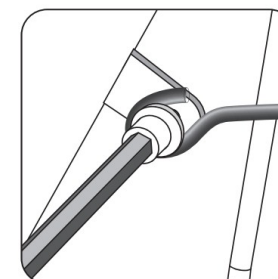
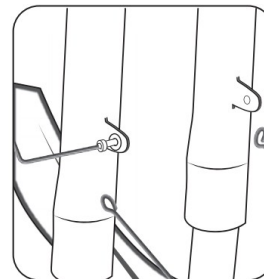

7.5 Installation Of Peda

7.5.1 Suitable For All Model

- Ensure that the threads of each pedal are fully inserted into the crank arm and fully tighten the pedals with a No.7 (M15 wrench) tool.

Note: Turn the pedal labeled "L" counterclockwise into the left crank and the pedal labeled "R" clockwise into the right crank.

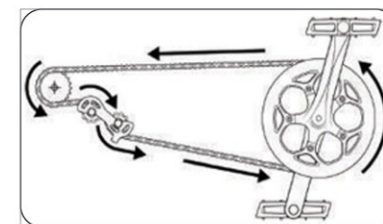
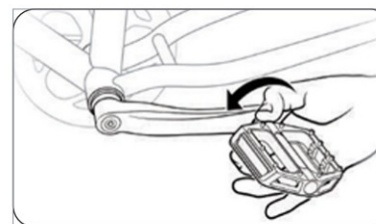
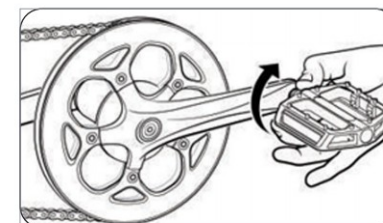
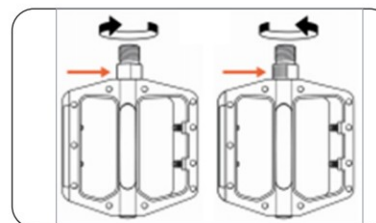

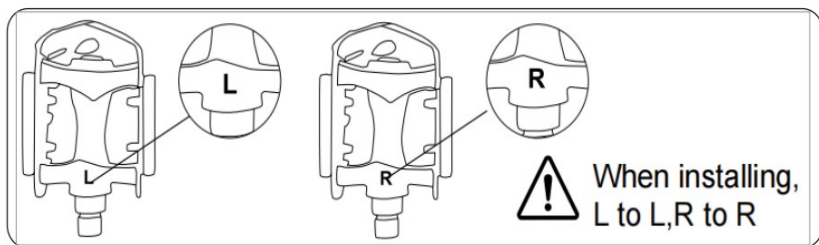

7.6 Mounting Saddle

7.6.1 Suitable For M26-2 PRO/M26-2 PLUS/S26-1 Model

- Connect the seat and seatpost first, then insert the seatpost into the bar receiver, adjust its position and adjust the height to suit your riding habits, tighten the seat with the clamp.

Note: Do not exceed the maximum saddle height and do not raise the saddle above the safety line!

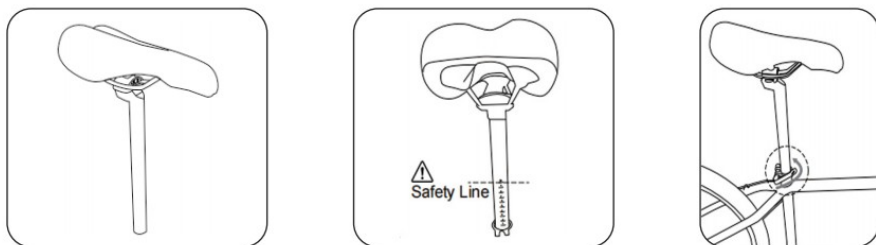

7.7 Installation Of Tail Light

7.7.1 Suitable For M26-2 PRO/S26-1 Model

- Remove the rear reflector from the accessory bag, install it in the proper position on the seat post, adjust the height and tighten the screws.

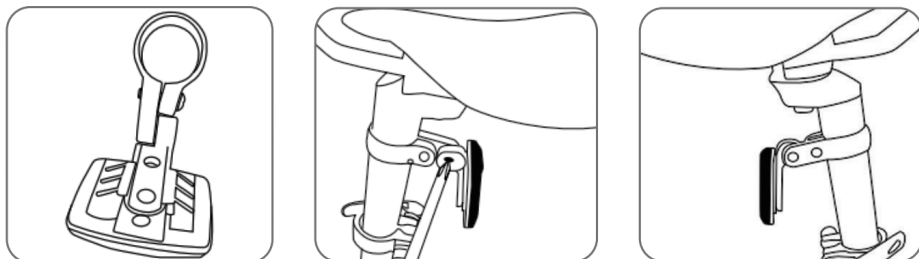

7.7.2 Suitable For S20-1/S20-1 PLUS/M26-2 PLUS Model E-Bike

- Remove the taillight, install the taillight on the rack and tighten the screws with a tool.
- Connect the plug of the taillight cable and bind the cable to the shelf with a tie wrap.

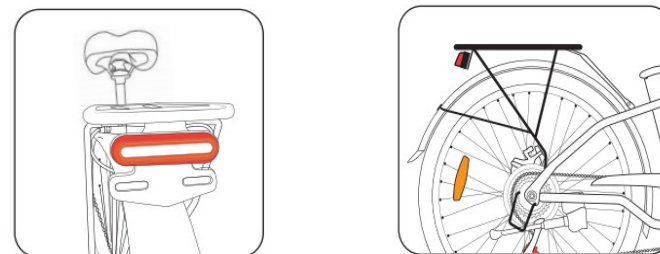

7.8 Installing The Battery

7.8.1 Suitable For M26-2 PRO/M26-2 PLUS/Plorer/X-Plorer Raptor /X-Plorer Beast/X-Plorer Monster/S20-1/S20-1 Model

- Open the battery compartment, place the battery at the correct angle, gently insert the battery into the holder, press it down and it will lock automatically. Insert the key into the keyhole and rotate the key to align it with the "OFF" icon, the battery is now locked and cannot be removed.

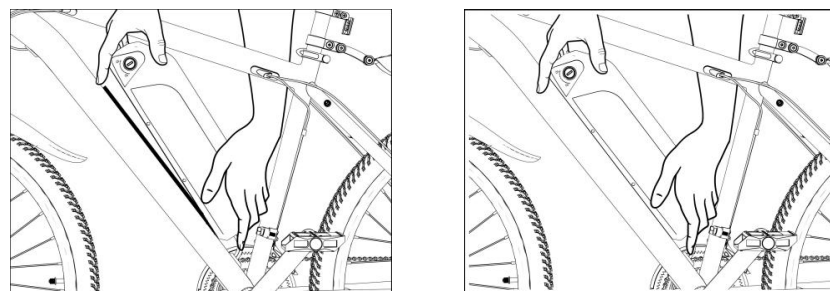

7.9 Adjust The Angle Of The Brake Levers, Gauges, Shifter, Throttle, And Bell On The Handlebars, Then Tighten With a Tool

After doing the above steps, then the installation part is successfully completed.

08. INSTRUCTIONS FOR USE

8.1 Meter Introduction

8.1.1 Suitable For M26-2 PRO/M26-2 PLUS/Plorer/X-Plorer/S26-1/S20-1/S20-1 PLUS Model

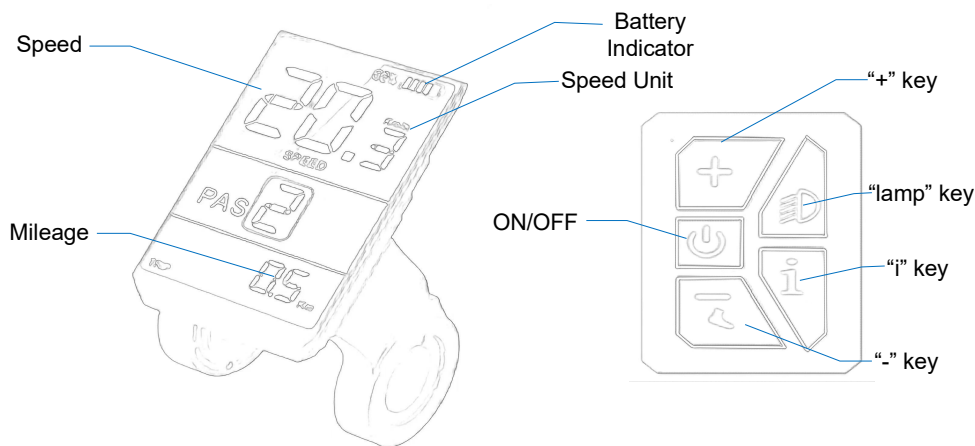

There are five keys on the operation unit corresponding to the J-56C instrument, including on /off key, "+"key, "-" key, and light key and function keys "i".

Setup Instructions:

- **Single Mileage Clear 0:** TC represents the zero clearance of a single mileage. Y / N can be selected by long pressing the "+" "-" button, and Y indicates the single mileage. N means no single mileage. Short, under the TC-Y Press "i" Press the button to confirm the function of "single mileage zero".
- **Assisted Push:** When the meter is on, long press [DOWN], after 3 seconds, the electric vehicle enters into the electrically-assisted push state. The electric vehicle drives at a constant speed of 6 kilometers per hour. The screen displays Walk.
- **Unlocking the speed limit:** When the meter is on, long press "-" and "i" at the same time for three seconds to unspeed it.
- **Unit switching:** Enter engineering mode by long pressing the "+" and "-" buttons. U-1 represents the mile unit MPH, and U-2 represents the highway unit KM/H. You can switch between 1/2 by short pressing the 'i' key. Finally, long press the "i" key to confirm the unit.

8.1.2 Suitable For X-Plorer Raptor /X-Plorer Beast/X-Plorer Monster Model

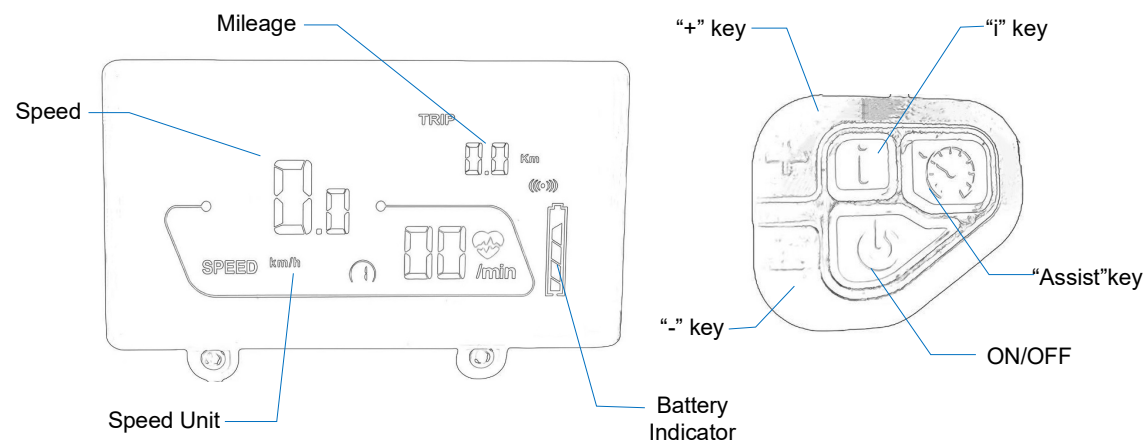

There are five keys on the operation unit corresponding to the DP-180-2 instrument, including on /off key, "+"key, "-" key, and Assist key and function keys "i".

Setup Instructions:

Speed Limit : Press and hold the "i" key for three seconds to enter the settings, adjust to the "05" interface, press and hold the 'i' key again to enter the modification mode, press the "+" key to increase the parameter, press the "-" key to decrease the parameter, then press and hold the "Assist" key to save and exit the settings mode, and return to the main interface.

Backlight brightness (1-3 levels): Press and hold the "i" key for three seconds to enter the settings, adjust to the "07" interface, press and hold the 'i' key again to enter the modification mode, press the "+" key to increase the parameter, press the "-" key to decrease the parameter (3 is the highest brightness), then press and hold the "Assist" key to save and exit the settings mode, and return to the main interface.

Mileage unit (0: KM; 1: MILE): Press and hold the "i" key for three seconds to enter the settings, scroll to the "04" interface, press and hold the 'i' key again to enter the modification mode, press the "+" key to increase the parameter, press the "-" key to decrease the parameter, then press and hold the "Assist" key to save and exit the settings mode, and return to the main interface.

Push mode: Press and hold the "Assist" button for 8 seconds to enter push mode. Press and hold the "Assist" button again for 8 seconds or brake to exit push mode.

8.1.3 Suitable For Plorer/X-Plorer/Model E-Bike.

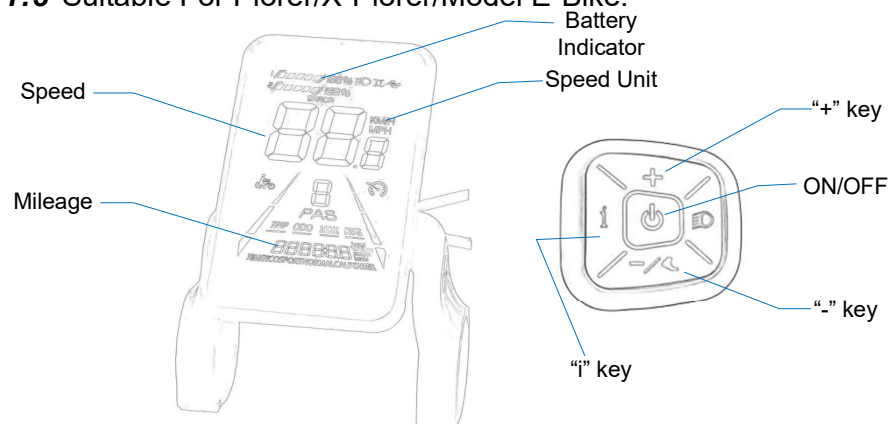

There are five keys on the operation unit corresponding to the 81F instrument, including on /off key, "+"key, "-" key, and light key and function keys "i".

Setup Instructions:

- **Single Mileage Clear 0 :** Press and hold the "-" and "i" keys at the same time for more than two seconds, the meter screen flashes, the operation is successful
- **Kilometer/Mile Conversion :** Press and hold the "-" and "+" key at the same time for more than two seconds to enter the setting interface. Then press "-" or "+" key briefly, the page shows P02, press "i" key briefly to enter the parameter change state, then press "-" or "+" key briefly to select the parameter, 01 stands for imperial system, 00 stands for metric system. After selecting the parameters, first short press "i" key, and then long press "i" key to complete the setup.
- **Assisted Push:** When the meter is on, long press "-", after 3 seconds, the electric bicycle enters into the electrically-assisted push state. The electric bicycle drives at a constant speed of 6 kilometers per hour. The screen displays Walk.
- **Unlocking the speed limit :** Press and hold the "-" and "+" keys at the same time for more than two seconds to enter the setting interface. Then press the "-" or "+" key briefly to adjust to the P08 interface. press "i" key briefly to enter the parameter change state, then press "-" or "+" key briefly to select the parameter, Adjust the value to 100, then the speed limit will be lifted successfully. After selecting the parameters, first short press "i" key, and then long press "i" key to complete the setup.

8.2 Battery Instructions

8.2.1 Suitable For M26-2 PRO/M26-2 PLUS/Plorer/X-Plorer/S26-1 Model E-Bike.

Before using this product, first you need to turn on the power switch on the side of the battery, press "-" to turn on the power switch. In key position ②, the battery is in the "locked" state, the battery is locked to the frame and the key is removed so that the bike can be ridden. In key position ①, the battery can be moved and removed. Press the "O" button on the side power button.

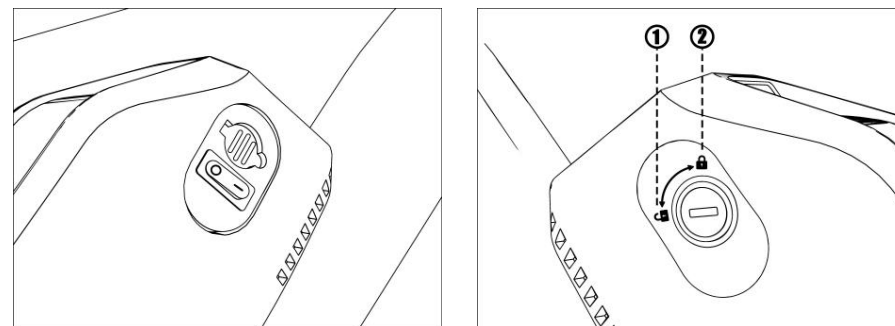

09. ADJUSTMENT AND USE OF BRAKE

9.1 Adjustment of Brake

Before aligning the mechanical disc brake, make sure that the brake cable is properly inserted into the lock lever. If the disc rotor is bent or damaged, replace the rotor first.

If the brake is not flexible, loosen the fixing bolt of the brake cable, shorten the braking distance of the brake cable, and then tighten the bolt.

Alternatively, when the brake is too sensitive, increase the distance of brake cable.

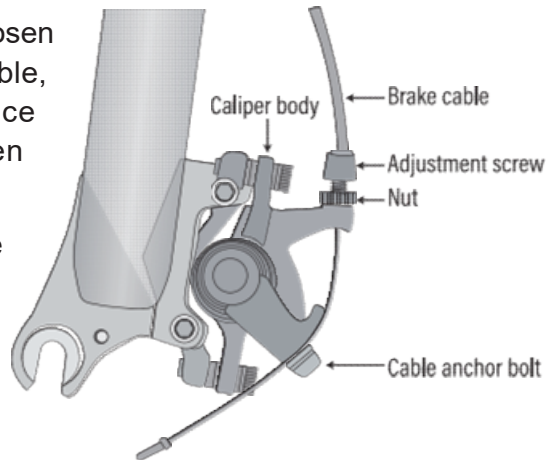

Leave the same clearance on both sides of the disc rotor

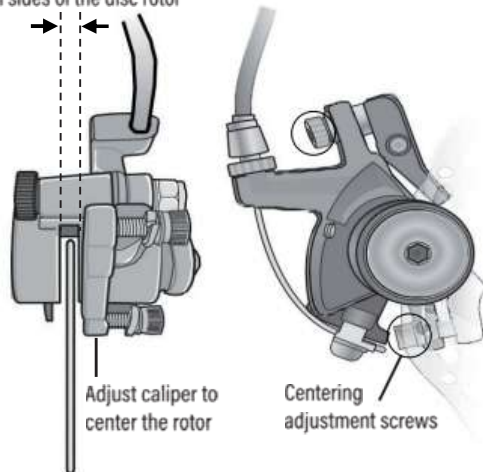

If the rotor is always rubbing against the brake pad or has excessive clearance, loosen the two centering adjustment screws, but do not remove them. Turn the wheel slowly and check the space between the rotor and the brake pad; adjust the position of the brake pad and rotor to avoid friction between the rotor and pad. After adjustment, tighten the screws.

You can also order brakes from specialized dealers. The dimensions are shown on the left (in mm):

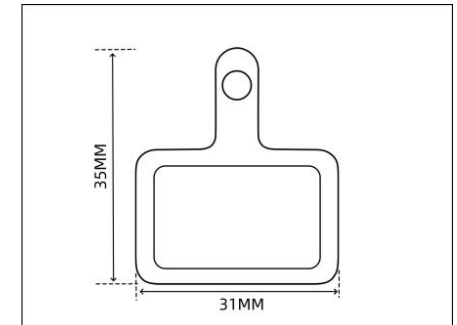

9.2 Use of Brake

The brake is used for speed control instead of stopping the bicycle alone. The maximum braking force of the wheel is available before the wheel "lock" (still) and subsequent slip. Once tires skid, most of braking power and any control over bicycle will be lost. You must practice braking and stopping gently without blocking wheel. This technique is called progressive brake modulation.

- Push the lock lever towards the handlebar to gradually increase the braking force.
- If the wheels get stuck, reduce the braking force so wheels can continue to spin without being stuck.

10. CHARGING: GUIDELINES FOR SAFE HANDLING

10.1 Please note

- Please follow the instructions for use. Otherwise you will be responsible for the consequences thereof.
- Please use the original special charger, and do not use other chargers.
- Note the chargeable battery type and applicable voltage. Do not use different types of battery in mixture. The charging time shall not exceed 12 hours and the charging current shall not exceed 3A.

10.2 Operating Instructions

- Insert the charger probe into the charger port on the electric bike battery as shown in the figure.
- Insert the tip of the wire into the battery charger.
- The red indicator will then on and stay red until the battery is fully charged. After the battery is fully charged, the indicator will become green.

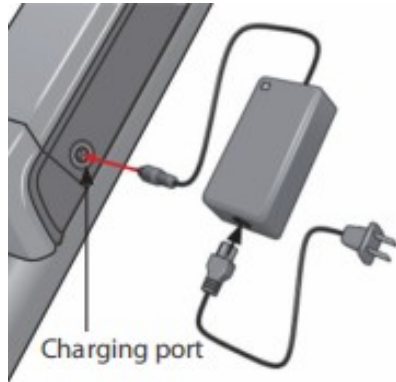

11. ERROR CODES

If there is an electrical problem, "Error" and an error code will be displayed. The detailed meaning of the error is:

Error Code	Define
21	Abnormal Current
22	Abnormal Oil Pressure
23	Motor Phase Error
24	Abnormal Motor Hall Wires
25	Abnormal Braking
30	Communication Exception
31	On/Off Button Sticks
34	6Km Function Button Adhesion

12. PRODUCT TROUBLESHOOTING AND METHODS

Fault Phenomenon	Fault Judgment	Fault Resolution
Dial indicator does not light up, motor does not rotate	Battery voltage in undervoltage condition	Charge now
	Battery life is exhausted	Battery replacement
	Bad power lock.	Replacement of power lock
High-speed operation of the motor cannot be controlled after the power lock is turned on	Adjust the handle and the controller three wires in the wrong position	Reconnect
Headlights don't work.	Damaged headlight switch	Replacement of switch
Motor turns on and off	Poor battery contact	Adjust or polish contacts
	No contact when power lock is burned out	Replacement of power lock
Short distance traveled on a Single battery charge	End of battery life	Battery replacement
	Battery voltage mismatch	Battery maintenance or battery replacement
Battery not charging or undercharging	Battery life is exhausted	Battery replacement
	No output from charger	Replacement of the charger
	Poor contact between charger and charging socket	Replacement of charging socket

Fault Phenomenon	Fault Judgment	Fault Resolution
Controller component burned out	Component burnout due to water ingress and short circuit in the controller	Replacement of the controller

13. PRODUCT PRECAUTIONS

13.1 Precautions for charging

- During charging, put the battery in a safe place out of the reach of children.
- The battery of electric bike must be stored in the environment with a temperature range of -20 to 45°C. Do not place the electric bike at a place with the temperature exceeding 45°C. When the ambient temperature is lower than -20°C, the battery will be self-locked and cannot be charged or used.
- Keep the battery dry. Do not put it in acid/alkali liquid and keep it away from rain, fire or high temperature. Keep metal contacts clean if necessary. Clean them with a soft, dry cloth.
- It is strictly forbidden to reversely connect the positive and negative poles of the battery, it is strictly forbidden to connect the positive and negative poles of the battery, and it is strictly forbidden to damage, disassemble or short-circuit the battery.
- Do not disassemble the battery without permission, and do not perform any unreasonable operation of the battery or unreasonably use it.
- Please use original battery. Do not change it with other brands or products.
- Use the original charger. Please do not use other charger brands or other batteries for this charger.
- Do not cover the charger during charging.
- Do not use the battery when not being fully charged.

- Before charging the electric bike, make sure that the charging port is dry and free of malfunctions and foreign objects. Only use the correct socket (100V-240V/50HZ-60HZ) for charging. When charging the electric bike, keep away from children and pets and make sure there are no flammable objects nearby.
- Do not use the electric bike while charging or connecting to a charger in any case.
- Be sure to lock the battery with the attached battery key and pull out the battery key before using the electric bicycle. Please keep the key properly. If it is lost, the user shall be fully responsible.
- If you completely immerse the battery or charger in water by accident, please power off the product immediately, disconnect the motor from the battery and stop charging, then contact us for technical support in time, and do not restart the product until we conduct a guide testing.

13.2 Battery Handling Precautions

- Recycle or discard the battery in an environment-friendly way.
- Do not throw the battery into fire. The battery may be exploded or leaked.
- Do not discard the battery in ordinary household garbage.



13.3 Precautions For Riding

- Night Riding

Riding a bicycle at night is much more dangerous than riding during the day. A bicyclist is very difficult for motorists and pedestrians to see. Therefore, children should never ride at dawn, at dusk or at night. Adults who chose to accept the greatly increased risk of riding at dawn, at dusk or at night need to take extra care both riding and choosing specialized equipment that helps reduce that risk.

- WARNING - ON AND OFF ROAD CONDITIONS:

The condition of the riding surface is very important. If the surface is wet, or has sand, leaves, small rocks or other loose debris on the surface where you plan to ride, carefully decrease the speed of the bicycle and ride with extra caution. It will also take a longer time and more distance to stop. Apply the brake earlier than normal and with less force. rear brake first followed by the front brake if equipped, to help keep the bicycle from sliding or falling.

- WARNING-STEM TO FORK

Failure to properly tighten handlebar components may result in loss of control, serious injury or death. Always check the handlebar cannot move and is secured to the frame before riding the bicycle.

14. PRODUCT MAINTENANCE INSTRUCTIONS

WARNING!

- Failure to conduct maintenance on the bicycle may result in malfunction of a critical part and serious injury or death. Proper maintenance is critical to the performance and safe operation of the bicycle.
- The recommended intervals and need for lubrication and maintenance may vary depending on conditions the bicycle is exposed to. Always inspect the bicycle and conduct necessary maintenance before each use of the bicycle.

This section presents important information on maintenance and will assist you in determining the proper course of action to take if you do have a problem with the operation of the bicycle. If you have questions regarding maintenance, please contact our customer service. Mailbox: support@varunebike.com or see a qualified bicycle mechanic.

Correct routine maintenance of your new bike will:

- Smooth running
- Longer lasting components
- Safer riding
- Lower running costs

14.1 BASIC MAINTENANCE

The following procedures will help you maintain your bicycle for years of enjoyable riding

- For painted frames, dust the surface and remove any loose dirt with a dry cloth. To clean, wipe with a damp cloth soaked in a mild detergent mixture. Dry with a cloth and polish with car or furniture wax. Use soap and water to clean plastic parts and rubber tires. Chrome plated bikes should be wiped over with a rust preventative fluid.
- Store your bicycle under shelter. Avoid leaving it in the rain or exposed to corrosive materials.
- Riding on the beach or in coastal areas exposes your bicycle to salt which is very corrosive. Wash your bicycle frequently and wipe or spray all unpainted parts with an anti-rust treatment. Make sure wheel rims are dry so braking performance is not affected. After rain, dry your bicycle and apply anti-rust treatment. If the hub and bottom bracket bearings of your bicycle have been submerged in water, they should be taken out and re-greased. This will prevent accelerated bearing deterioration.
- If paint has become scratched or chipped to the metal, use touch up paint to prevent rust. Clear nail polish can also be used as a preventative measure.

Regularly clean and lubricate all moving parts, tighten components and make adjustments as required.

14.2 LUBRICATION SCHEDULE

Component	Lubricant	Method
Weekly		
Chains	Chain lube or light oil	Brush on or squirt
Brake calipers	Oil	Three drops from oil can
Brake levers	Oil	Two drops from oil can
Freewheel	Oil	Two drops from oil can
Deraillleur Systems	Light oil or grease	All pivot points should be lubricated (more often in severely rainy or muddy conditions). Wipe off any excess oil.
Brake cables	Lithium based grease	Remove cable from casing. Grease entire length, Wipe off excess lubrication from other surfaces.
Brake lever and caliper pivot points	Light oil	Two to three drops from oil can
Shifting cables	Thin layer of grease	Clean and grease
Yearly		
Bottom bracket	Lithium based grease	Disassemble
Pedals	Lithium based grease	Disassemble

Component	Lubricant	Method
Wheel bearings	Lithium based grease	Disassemble
Headset	Lithium based grease	Disassemble
Seat stem	Lithium based grease	Disassemble
Pedals: that can be disassembled	/	See bicycle mechanic for maintenance.

Note: The frequency of maintenance should increase with use in wet or dusty conditions, Do not over lubricate. Remove excess lubricant to prevent dirt build up, **Never** use a degreaser to lubricate your chains

14.3 PARTS MAINTENANCE

Tires **Frequency:** inspect and maintain at least each use

Inspect	Action	Maintenance
Tire Inflation	Check tire pressure	inflate tire to the pressure indicated on the tire sidewall. see "inflating a Tire Tube" for more detail. if the tire is flat see "Fixing a flat Tire" for more detail.
	Check the bead is properly seated while inflating or refitting the tire.	Reduce air pressure in the tube and re-seat the bead.
	Spin wheel and check rotation /alignment is smooth and even.	Loosen axle nut(s) and adjust until properly seated. If the hub bearings need repair see a bicycle mechanic for repair.

Inspect	Action	Maintenance
Bead Seating	Check for broken or loose spokes.	See bicycle mechanic for repair.
Tread	inspect for signs of excessive wear, flat spots or cuts and damage,	Replace tire.
Valves	Check that valve caps are fitted and free of dirt	Clean dirt from the valve.

Wheels **Frequency:** inspect and maintain at least each use

Inspect	Action	Maintenance
Rims	inspect for dirt and grease.	Use a clean rag or wash with soapy water, rinse, and air dry
Wheels	Check the wheels are securely fastened to the bicycle and axle nuts are tight.	Adjust if necessary and tighten axle nuts.
	Spin wheel and check rotation / alignment is true	See bicycle mechanic for repair.
Spokes	Check for broken or loose spokes.	See bicycle mechanic for repair.
Hub Bearings	Lift each wheel and see if there is movement side to side.	See bicycle mechanic for repair.

Drivetrain (pedals, chains, chainwheel, crank set, freewheel)

Inspect	Action	Maintenance
Pedals	Every month, check each pedal is securely set and tighten into the crank arm.	If necessary, re-set and tighten.
	Before each ride, check each front and rear pedal reflectors are clean and in place.	Clean or replace
Pedal Bearings	Every ride, check the pedal bearings are properly adjusted. Move the pedal up and down, left and right, If looseness or roughness is detected adjustment, lubrication or replacement is required.	See bicycle mechanic for repair
Chains	Every week, check the chain is clean, properly lubricated rust-free, and is not stretched, broken, or has stiff links.	Lubricate if necessary, Replace if rusted, stretched, or broken.
Crank Set	Every month, check the crank set (crank arms, chain rings, and bottom bracket axle and bearings) is correctly adjusted and tight.	See bicycle mechanic for repair.

Brakes

Frequency: Inspect and maintain before each use

Inspect	Action	Maintenance
Lewers	Check the levers are securely fastened to the handlebar.	Position the levers to fit the rider's grip and screw tight to handlebar.
Pads	Check pad position, gap and pressure.	See Section 9: Adjusting the Brakes
Cables	Check the outer casing for kinks, stretched coils and damage Check cables for kinks, rust, broken strands or frayed ends. Check the outer casing for kinks, stretched coils and damage	Replace cable.
	Check the housing is seated properly into each cable stop of the bicycle. Maintenance	It is recommended that the cables and housing be replaced every riding season.

14.4 HUB BEARINGS

Hub bearings require special thin wrenches called **cone wrenches**, if you do not own these tools, do not attempt hub bearing adjustments, Have a qualified bicycle mechanic perform the adjustment if you have any doubts.

- Check to make sure neither locknut is loose
- To adjust, remove wheel from bicycle and loosen the locknut on one side of the hub while holding the bearing cone on the same side with a cone wrench,

- Rotate the adjusting cone as needed to eliminate free play
- Re-tighten the locknut while holding the adjusting cone in position.
- Re-check that the wheel can turn freely without excessive side play.

14.5 INFLATING THE TIRE TUBE

WARNING!

- An unseated tire can rupture unexpectedly and cause serious injury or death, Be sure the tire is properly seated when inflating the tube.
- Over inflation or inflating the tube too quickly may result in the tire blowing off the rim and damaging the bicycle or causing injury to the rider, Always use a hand pump to inflate the tube. Do not use a gas station service pump to inflate the tube.

Follow these steps to inflate a tire:

- Remove the valve cap and add air.
- Be sure the tire is evenly seated on the rim, both sides.
- Spin the wheel and check for high and low areas.
- Complete inflation to the recommended psi found on the sidewall of the tire.
- Be sure the tire is evenly seated on the rim, both sides. If not, release some air and repeat steps three through six.
- Check for dirt in the valve cap or stem, Clean dirt from cap or stem.
- Securely replace the valve cap on the stem,

15. WARRANTY STATEMENT

In addition to the statutory warranty, VARUN grants electronic components such as “motor”; “Control Unit”; “Display” and “Battery” one year warranty after customer registration.

Wear parts such as “brakes”; “caliper”; “brake pads”; “Lamps” etc. are excluded from the guarantee. Defects caused by an accident or improper handling are fundamentally excluded.

15.1 Any of the following will void the warranty

- Failure to follow all instructions or recommendations listed in the user manual.
- Single vehicle collision, accident or vehicle damage caused by careless parking.
- Illegal behavior.
- Never registered your e-bike or could not provide an order number.
- DIY repair electronic products.
- Misuse of bicycles on off-road terrain, dirt, snow, water, sand, gravel and water.
- If the bicycle is used as a rental unit.
- Damage caused by earthquake, lightning, fire, flood and other natural disasters.
- Prolonged exposure to rain, hail, snow or direct sunlight can cause rust and/or paint discoloring.
- Overload exceeds recommended load.
- Damage caused by nails, needles, broken glass, debris, sharp stones or other foreign objects.
- Jumping from ramps, stairs or elevated ramps if the bike is used for, but not limited to, stunts.
- If the vehicle is used for competition or racing.
- If modifications have been made to the engine, electrical system, suspension and battery for any purpose.

- Use of other components not approved by the manufacturer.

Damage caused by improper care and handling.

- Due to the nature of the product, some components must be unique to the manufacturer, such as, but not limited to, batteries, motors, gauges, controllers, Led headlamps, brakes or brake pads. Other components such as tires, inner tubes, saddles, racks, baskets may be used from listed or compatible products pre-approved by the retailer or manufacturer.
- If you have any questions about the warranty or to make any claims, please contact VARUN Service at:
- Email: support@varunebike.com

16. FAQ

Q: How does customer service/warranty work after the sale?

A: When you have a problem with your bike, please leave us a message on the platform where you bought your bike or contact us directly: support@varunebike.com

We will get back to you within one business day. It is best to describe your problem in detail and send pictures or make a video showing your problem. We will report your problem/video to our technical team and give you a solution.

Q: Can I ride in the rain?

A: Yes, there is no problem riding in moderate or light rain. Please make sure that the bike is completely dry before your next ride, and make sure that the bike is completely dry before your next ride, otherwise the bike will randomly disconnect. However, do not park your bike in the rain or wade through water. Soaking the vehicle and electrical components in water is prohibited.

Q: What is the most important thing I can do to maintain my battery?

A: Remember to charge your bike in a timely manner and do not leave it with an empty battery. Remember, if you don't use the battery for a long time, charge the battery every 2 months or the battery will starve to death because it has no power. No power. This will result in short trips or the display not coming on.

Q: Do you have a spare key for my e-bike?

A: Hi, we don't have a spare key, please keep your key safe in case you lose it.

Q: What is the range of my VARUN battery?

A: This depends on the situation, on factors such as the battery itself (capacity, condition, charging cycles); the landscape (even in the mountains); the weather (tailwind or headwind, cold/warm); the power support (low/high), etc. It is generally impossible to answer. Under laboratory conditions, each VARUN bike was driven over 100 kilometers during the test. It is recommended that you use the Pedal Assist mode, which improves range.

Q: From time to time, my display gives me errors, flashes, and occasionally goes out instead of coming on!

A: There may be poor battery contacts here. First clean the contacts on the battery, spray with WD 40 / Caramba or similar product and check that the battery is correctly placed in the supplied stand. If the battery is wobbling in the support, secure it. If the display goes out while driving, the contact between the battery and the control unit may be broken. It also makes sense to check the contacts on the control unit directly here.

Q: I want to buy another bike!

A: Ask our sales people for a "loyalty discount" on another new bike or a cheap refurbished bike (1 year warranty). We are here to help, just send us an e-mail.

| 17. AFTER-SALES SERVICES

Category	Components	Warranty period
Power system	Battery	12 months
	Motor	12 months
	Controller	12 months
Electrical system	Instrument	6 months

Category	Components	Warranty period
Electrical system	integrated line	6 months
	Power-off brake handle	6 months
	Key switch	6 months
	Headlamp	6 months
	Sensor	6 months
Variable speed system	Left and right thumb shifters	6 months
	Fluted disc	6 months
Part 1	Charger	6 months
Part 2	Battery holder	6 months
Part 3	Pedal	6 months
Part 4	Crank	6 months
Part 5	Seat tube	6 months
Part 6	Seat cushion	6 months
Part 7	Seat clamp	6 months
Wear parts	Brake lining	1 months
	Internal and external tire	1 months
	Chain	1 months
Presented parts	Toolkit	0 months
	Mudguard	0 months

Notice:

Consumables and gift items are not included in the after-sales service. Warranty provisions cease to apply to any of following conditions, which are not quality problems.

17.1.1 Faults caused by operation not in accordance with the user manual.

17.1.2 Normal wear, accident, abuse, neglect, improper assembly, or improper maintenance of parts, and improper use of accessories by any user.

17.1.3 Parts that are subject to natural wear under normal use, or the circumstances inapplicable to the above warranty policy.

17.1.4 Failure of correct change and maintenance or faults and damage of other parts due to wear of consumables.

17.1.5 The warranty card does not match the bicycle model or the bicycle model is changed.

17.1.6 Damage caused by overloading, riding over obstacles (including but not limited to going down steps and falling), extreme sports, etc.

17.1.7 Damage caused by force majeure (such as fire, earthquake, lightning strike and flood).

17.1.8 Within the range of warranty policy, but beyond the warranty date.

17.1.9 Generally, a fully charged battery will endure 90 days in standby mode. Charge the battery after using every time. Depletion of battery power may damage battery permanently and the electronic device inside the battery will record the

charge and discharge of the battery. Damage caused by over-discharge or under-discharge is not covered by warranty service.

17.1.10 Damage caused by collision during the use of the product and its parts.

For any questions, please feel free to contact us. We will send you a reply and solve the problem within 24 hours.

Email: support@varunebike.com



VARUN

support@varunebike.com

